



214 Prodo Drive
Jefferson City, MO 65109

www.kolbproperties.com
573-893-7320

Trade Center Parkway

\$88,000 - ID: ID-2680 - Jefferson City - Land › Residential Income

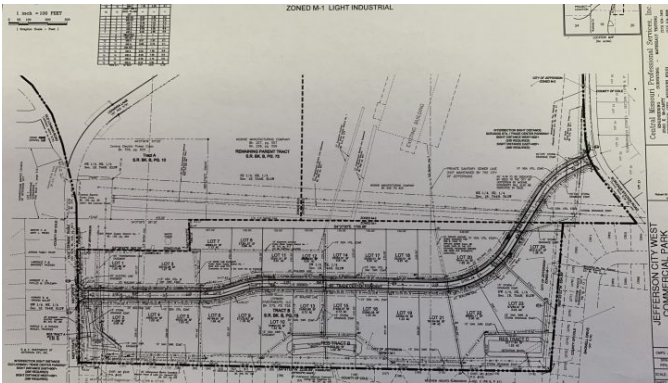

| | |
|----------|---------------|
| Zoning | PUD |
| Lot Size | 1 Acre Approx |

[Print Friendly, PDF & Email](#)

Residential Multi-Family Lots Available
24 lots ranging from .84 acres up to 2 acres
Most lots are approximately 1 acre usable
30.29 Acres available for \$1,250,000.00
Rolling to flat terrain
Excellent west end location near other Multi-Family
Plat and Aerial available upon request

Listing Gallery

Property Location



Chris Gates

[Print Friendly, PDF & Email](#)

Sales and Leasing for
Retail, Office, Warehouse,
Industrial, Investment & Residential Sales.

Email: chriswgates@kolbproperties.com

Phone: 573-644-4636

[See my listings](#)

Property URL

image not found or type unknown



<http://kolbproperties.com/property/trade-center-parkway/>